



# Strontium Gaming™

## Floorplans

### Floorplans 3 ~ Darkcloud Tower

by Bruce V. Edwards



This gaming material is provided free for personal use only. You may print these pages for use in your own RPG or miniatures games. This document may not be copied, redistributed, repackaged, or resold in any form.

The entire contents are copyright ©2004 by Bruce V. Edwards

This is a very nice fortified home that was originally intended as the hideout of a reclusive sorcerer who dabbled in golems. It can serve as the home or outpost for any individual of means. The living quarters on the top floor are quite roomy and nicely equipped. There is even a bathtub and the iron & ceramic stove is extremely high-tech. The first floor features an indoor well pump and plenty of space for a workshop of some sort.

The floorplans in this booklet can be printed for use on the tabletop with your fantasy game miniatures. A good paper choice is a heavy card stock (110 lb. or so, smooth finish); this works well in many printers and makes a suitably stiff playing surface.



This is what both levels look like all together. The ground level (the narrowest part of the tower) is solid stone; the outside portal leads back to the central spiral stairs which lead up to the first level (second story).

The first level (shown on the bottom) is an open area with a table, some shelves, a water pump, and a large iron cauldron. The stairs can, if you wish, be sealed with a semi-circular iron hatch. A ramp (not stairs) leads to the upper floor.

The top floor is reached by a wide and gently sloping ramp. There are two chambers; the living/sleeping quarters, and the bathroom/storage room.



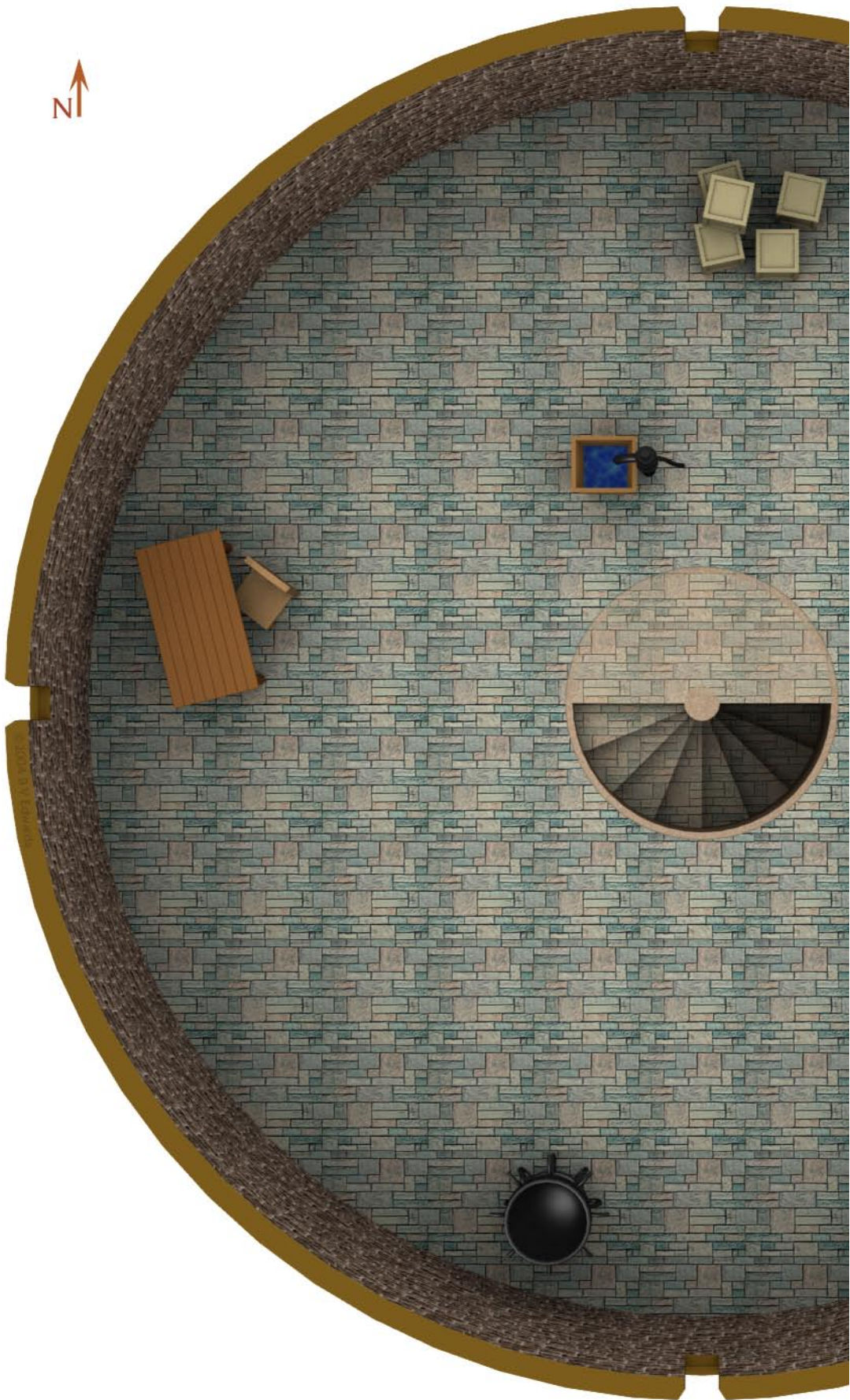

This and the next page need to be cut & pasted together; there is a large overlapping area.

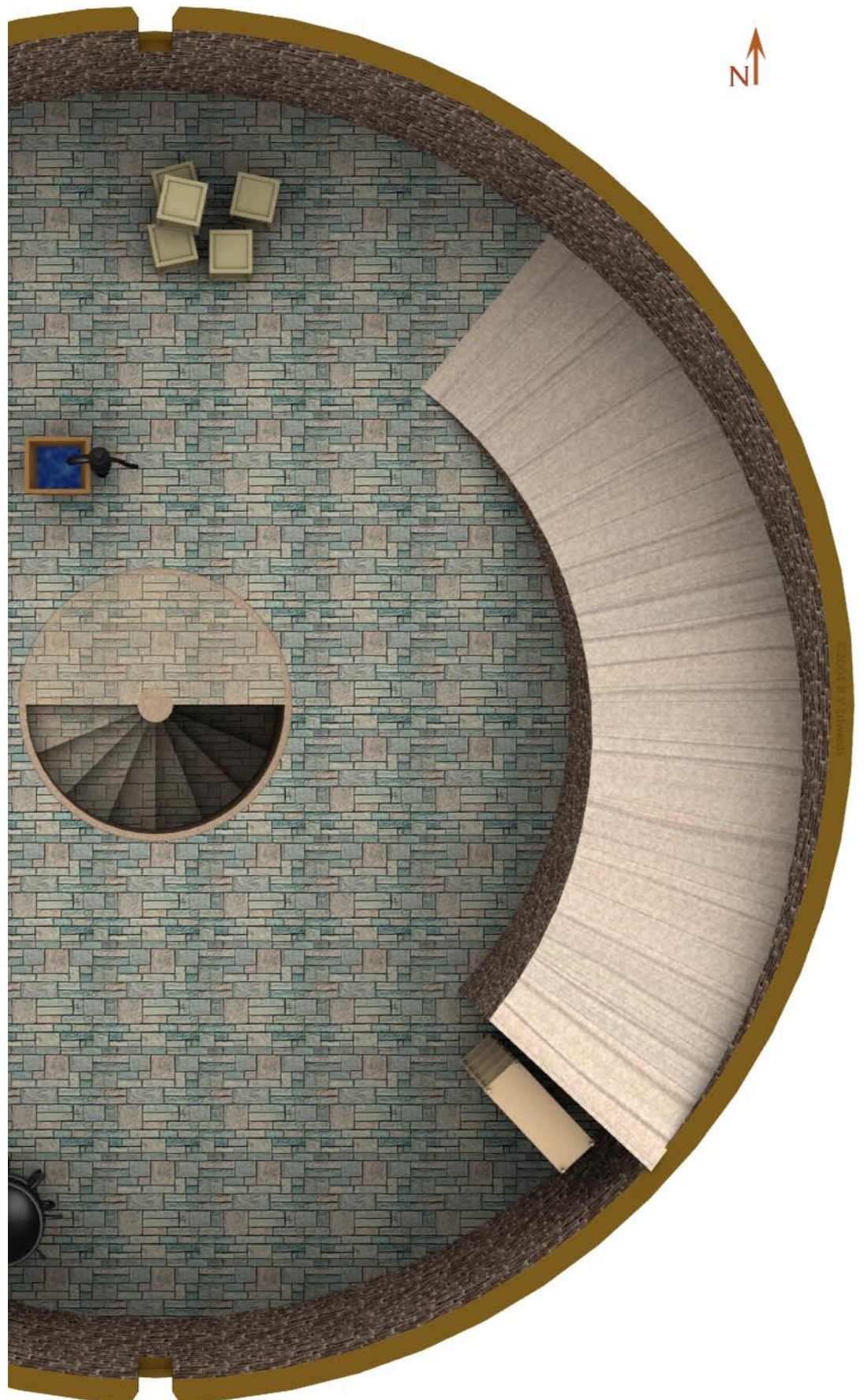

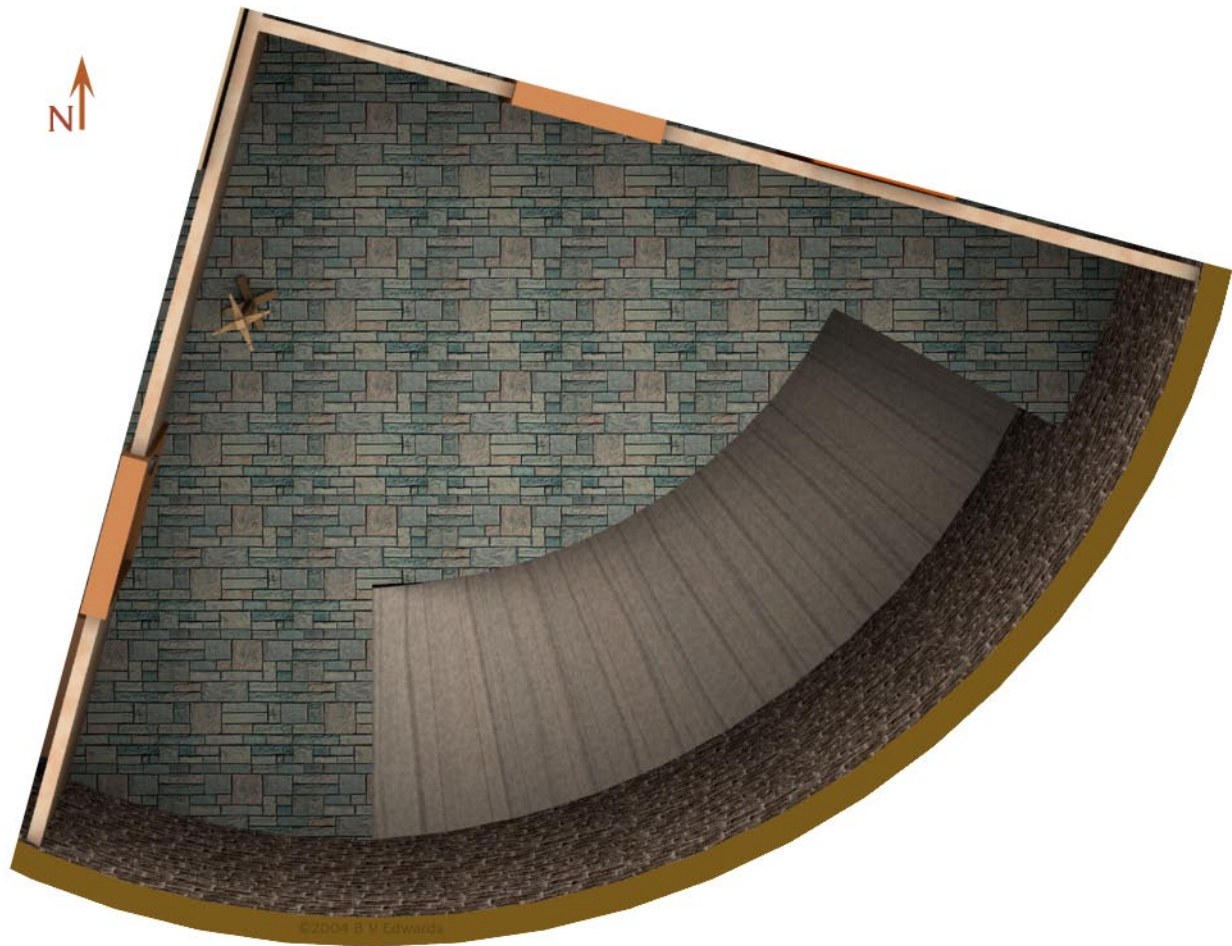

This is the first chamber of the second level; there is a coat rack here, but little else.

If you wish, the three parts of the second level can be pasted together into one large map.

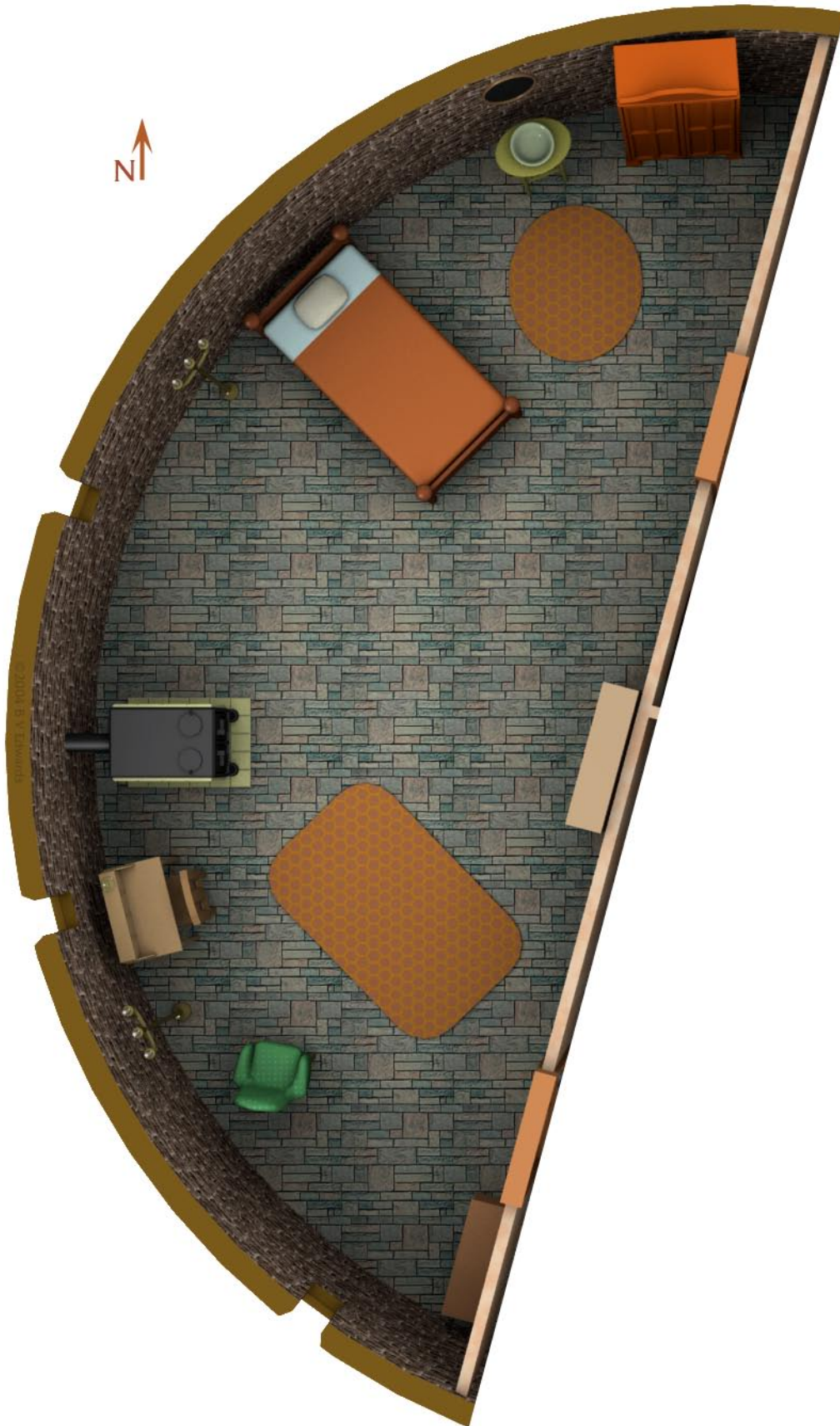

The main living quarters is finely furnished with an iron stove, a writing desk, washstand, wall closet, and so on.



The bathroom and storage area has another wall closet, a trunk, a small bath tub, and, of course, the potty (a wooden box with a ceramic or iron chamber pot inside).

Also note that this room has its own iron fireplace.