

SWORD COAST

1 hex = 5 miles



- City
- Town
- Ruins
- Point of Interest
- Peak
- Road
- Trail
- River
- Forest
- Marsh
- Hills
- Mountains

Neverwinter

Mount Hotenow

Neverwinter Wood

Starmetal Hills

Conyberry

The High Road

Triboar Trail

Phandalin

Leilon

Mere of Dead Men

Sword Mountains

Kryptgarden Forest

WAYSIDE INN

1 square = 5 feet

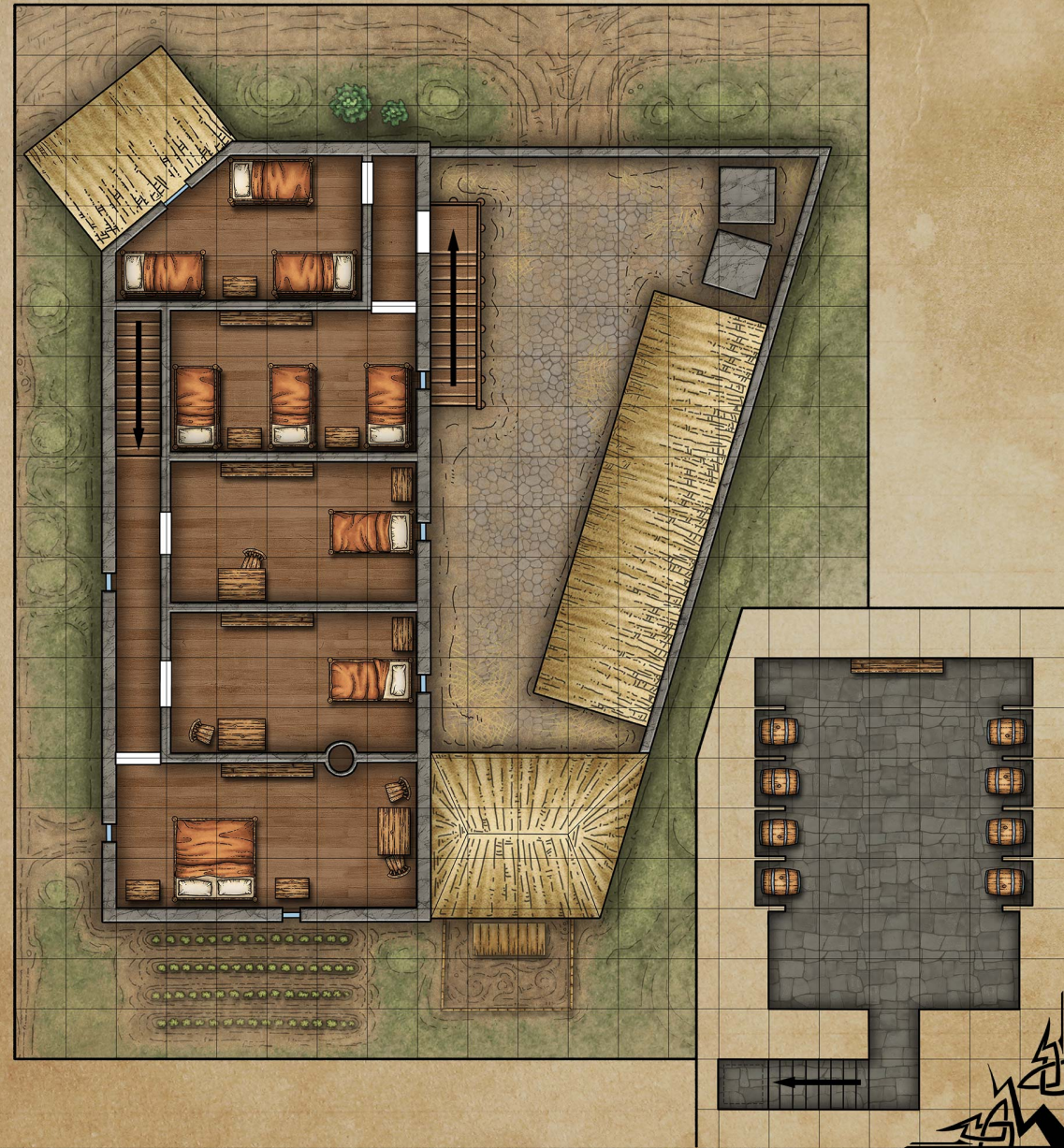



LEILON

BACKLOT IN TOWN

1 square = 5 feet



WAYSIDE INN

1 square = 5 feet

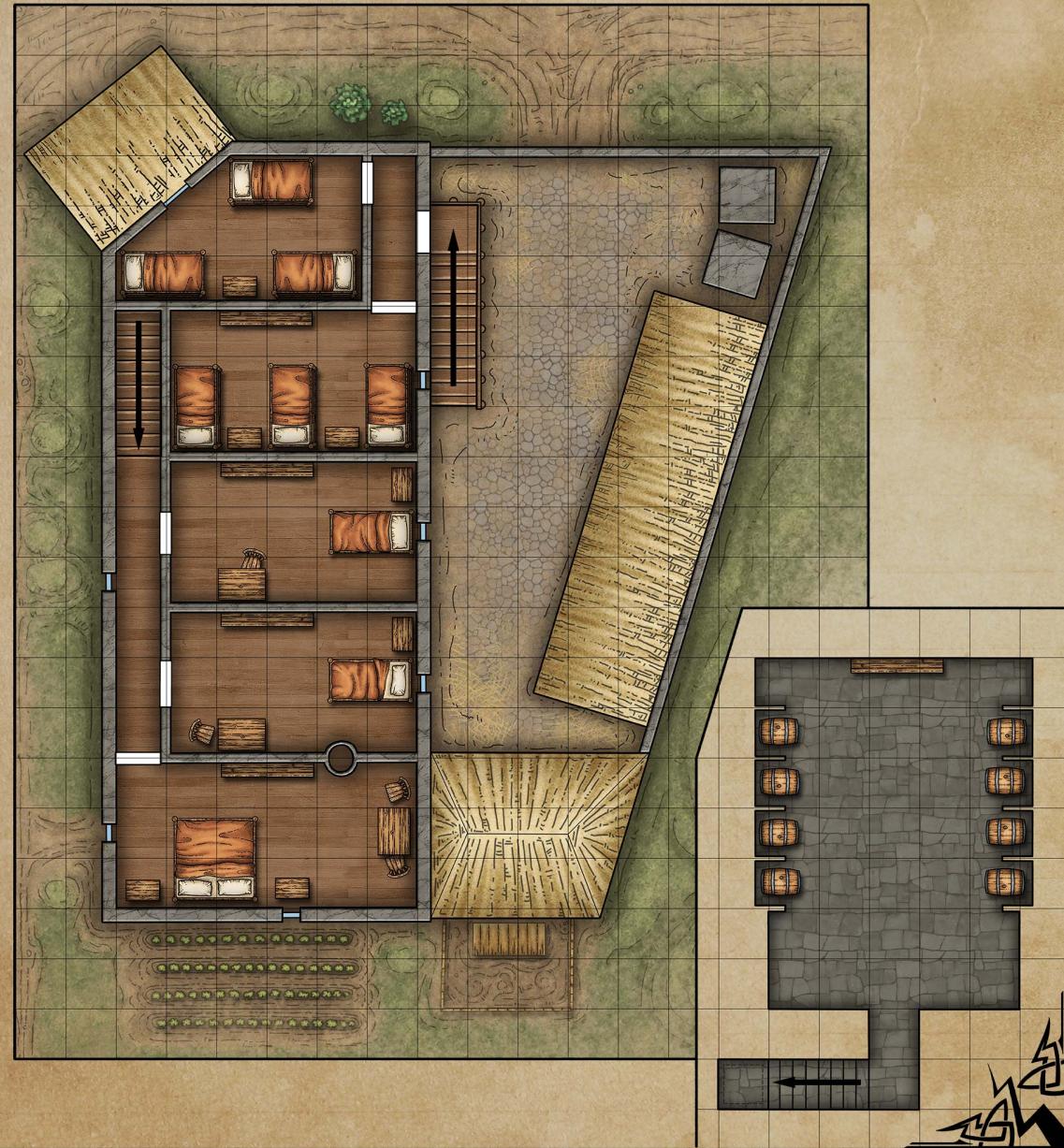

HOUSE OF THALIVAR

1 square = 5 feet

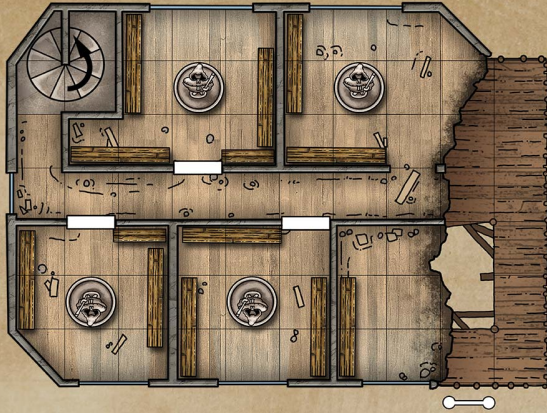

2ND FLOOR

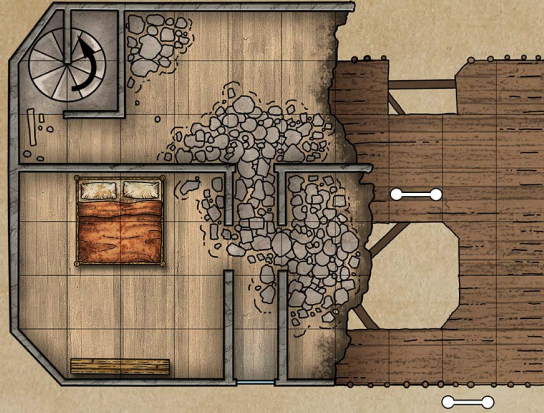

3RD FLOOR



1ST FLOOR

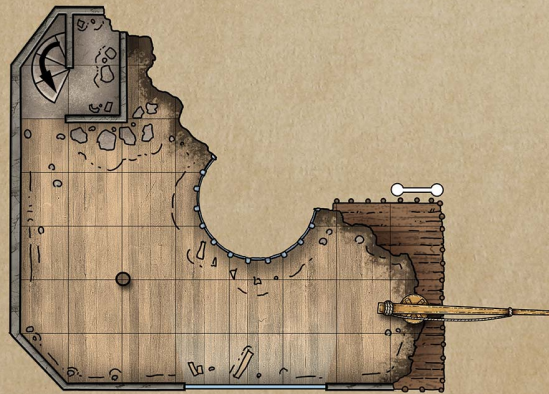

4TH FLOOR



MISSING PATROL

1 square = 5 feet



THUNDER CLIFFS

1 square = 5 feet

