

Korben Trollone's Office

Ptolus

ADVENTURE MAPS

Welcome to **Ptolus Adventure Maps: Korben Trollone's Office**. Inside you will find nine terrain tiles detailing two floors of this South Market business and the secrets that lie below it.

From within these walls "Korben the Keeper" operates a criminal organization that covers the entire South Market, collecting protection money from businesses, running a number of small-time gambling operations, and managing a pair of brothels.

Ptolus Adventure Maps feature detailed miniatures scale map tiles of locales pulled straight from the pages of Monte Cook's *Ptolus*! Simply print them, trim them out, and bring the excitement of the City by the Spire to your tabletop.



Ptolus

ADVENTURE MAPS

Korben Trollone's Office

Cartography and design

ED BOURELLE

Ptolus logo and cover pattern illustration

TODD LOCKWOOD

Ptolus created by

MONTE COOK

Editorial assistance

SUE WEINLEIN COOK



For more material on the City by the Spire visit

WWW.PTOLUS.COM

Look for FREE miniatures scale map tiles at

WWW.SKELETONKEYGAMES.COM

Print:

- Ptolus Adventure Maps are designed to be printed on your home printer.
- Print all the tiles or only the tiles you need - it is completely up to you.
- Each tile is offered on its own page so you can be selective and print only what you need.
- When printing, make sure that the *Print to Fit Page* option is clicked OFF so that the tiles will retain their one inch grid.

Trim:

- Trim out your Ptolus Adventure Maps with a sharp blade and a strait edge on a safe cutting surface.
- Where indicated, cut the tiles to the dashed line.

Connect:

- Use tape on the back of your Ptolus Adventure Maps to hold them together.
- Spray adhesive can be used to mount your tiles to a poster board.
- Mount the tiles to magnetic sheeting and trim for use on metal surfaces.

Play:

- Use miniatures or cardboard counters on your Ptolus Adventure Maps for infinite excitement.
 - Use markers to make notes and combat diagrams, you can always print more.
-

Adventure Maps: Korben Trollone's Office ©2006 Edward Bourelle. All illustration and cartography is ©2006 Monte J. Cook and is used under license. **Ptolus** is a trademark owned by Monte J. Cook and is used here under license from Malhavoc Press. All rights reserved. **SkeletonKey Games** is a trademark owned by Edward Bourelle. All rights reserved. The reproduction or retransmission of any part of this product, without written permission of the copyright holder is expressly forbidden, except for the purpose of reviews. Permission is granted to print this material for personal use only.

Product Code: SKGPAM01

Korben Trollone's Office

Ptolus page 360 (Chapter 16) / City Map #242, E7 (Penny Street)

The diagram below shows you how the printed pages should be assembled for use on the tabletop.

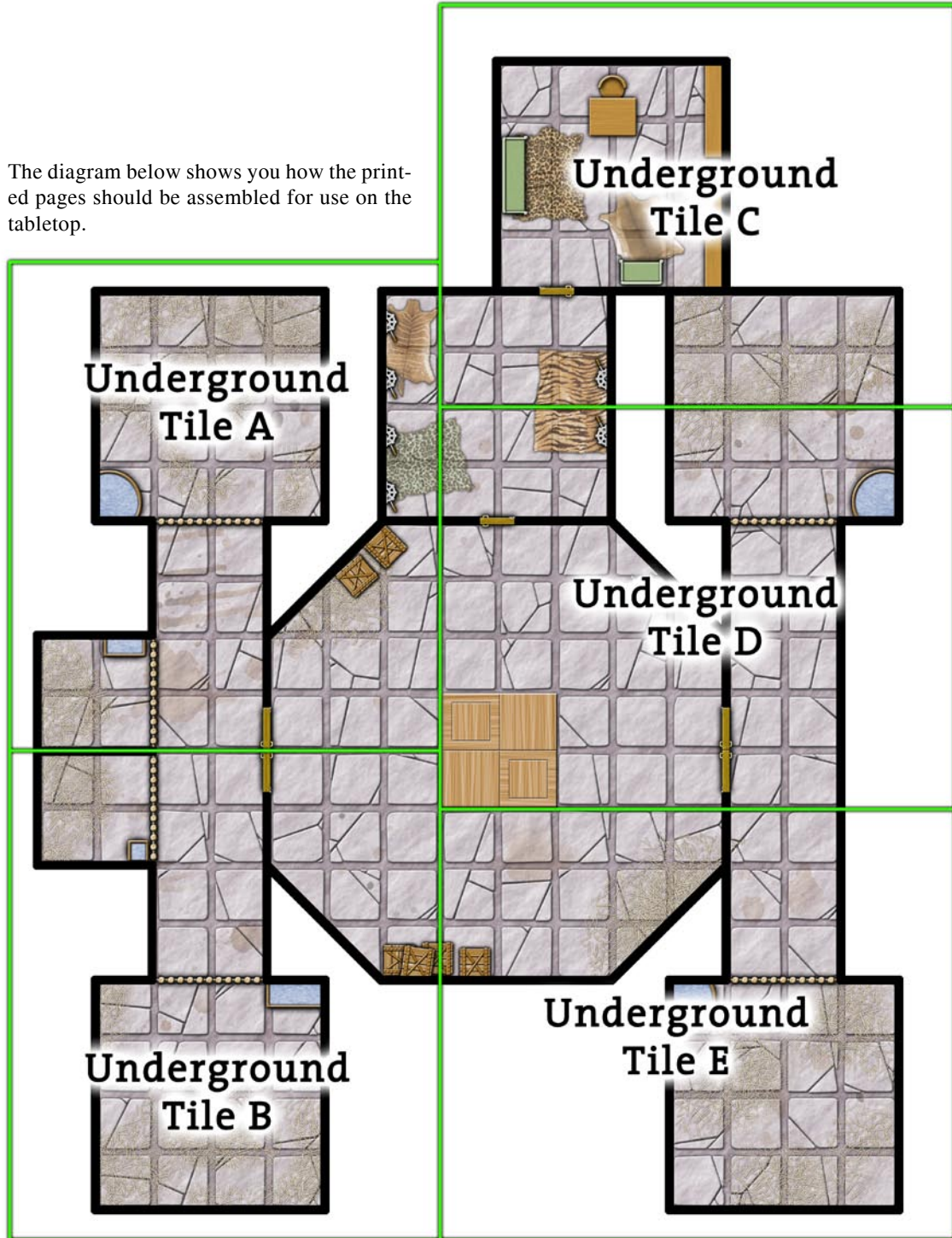

Ptolus Adventure Maps: Korben Trollone's Office - UNDERGROUND TILE A

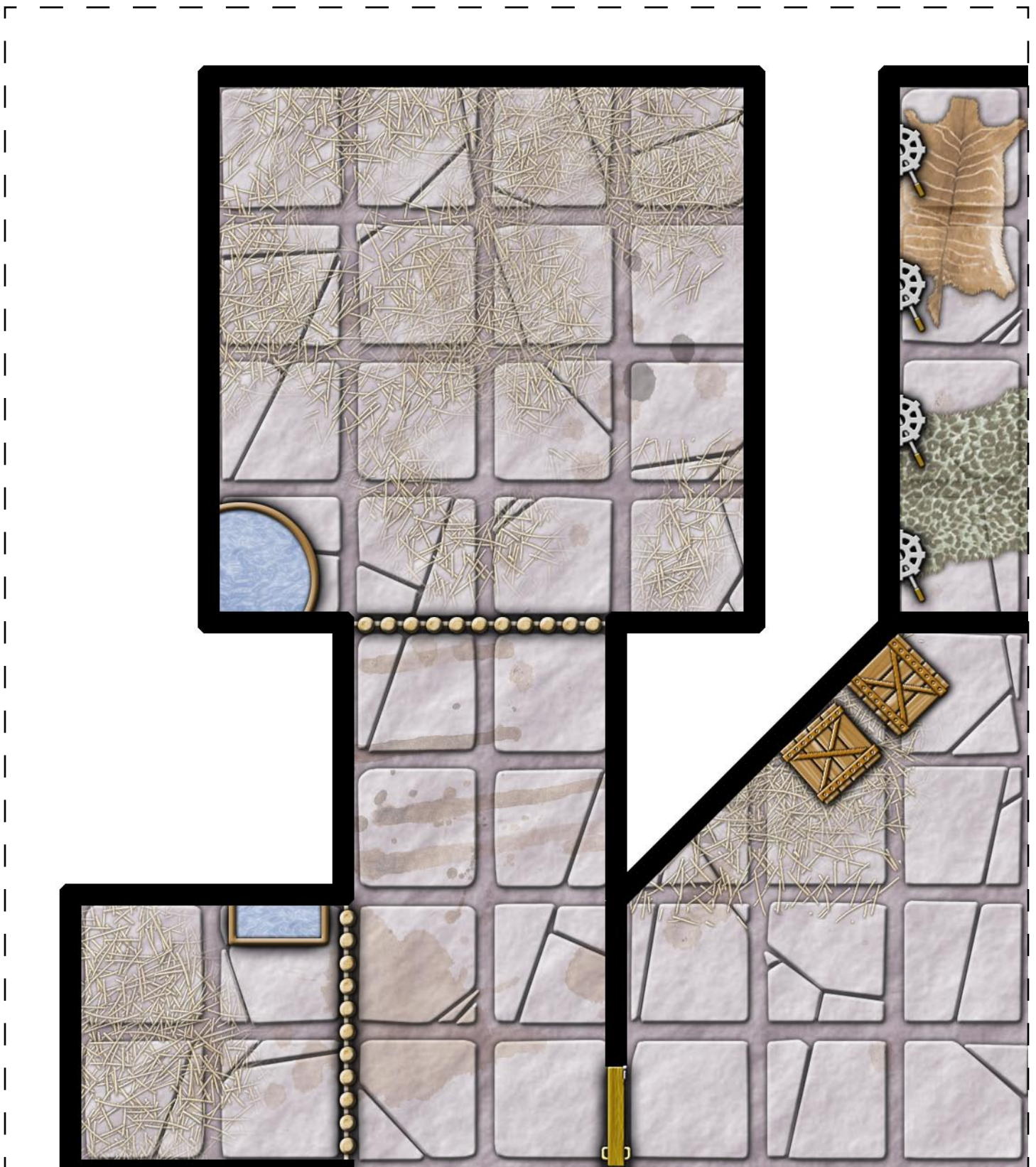

Ptolus Adventure Maps: Korben Trollone's Office - UNDERGROUND TILE B

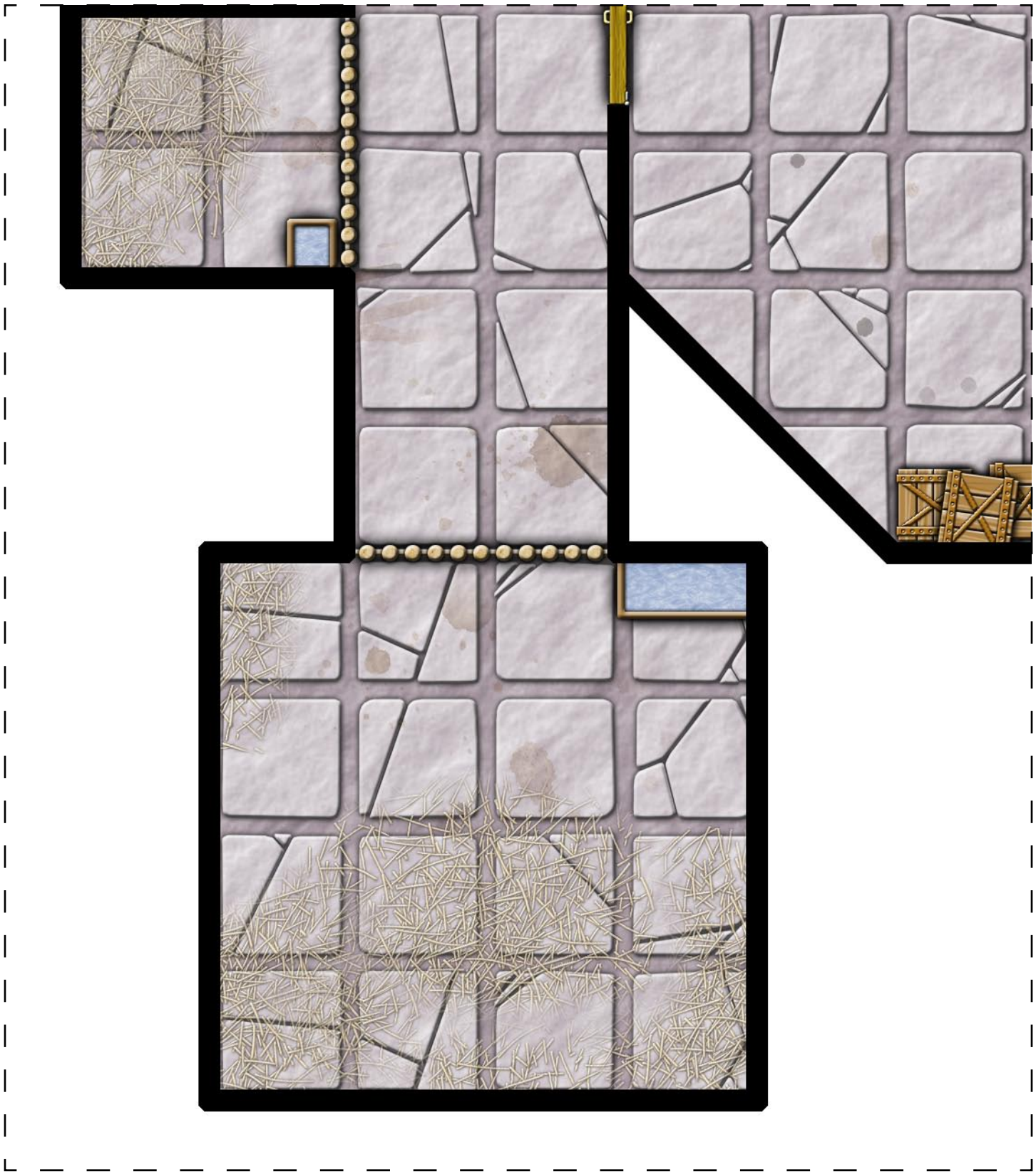

Ptolus Adventure Maps: Korben Trollone's Office - UNDERGROUND TILE C

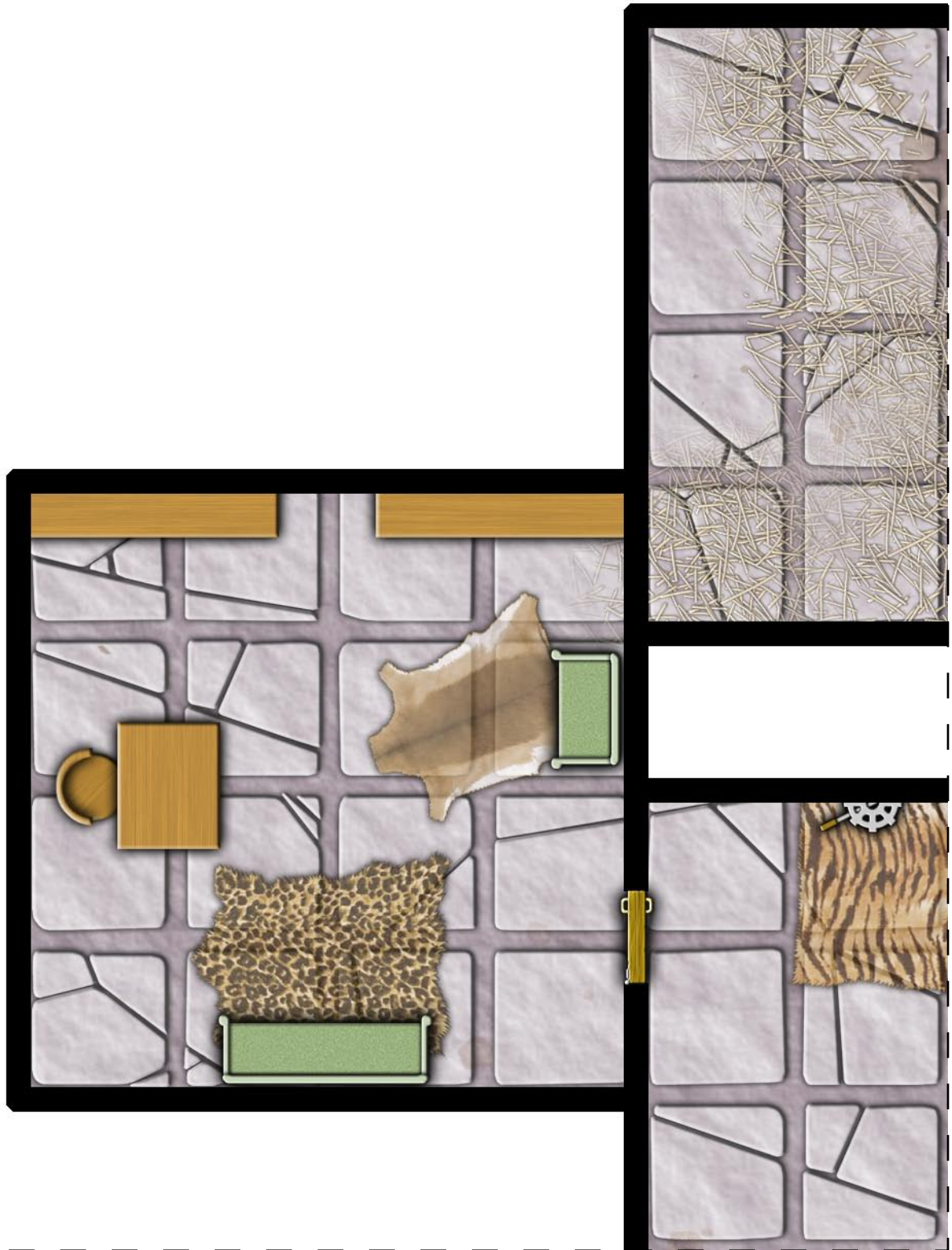

Ptolus Adventure Maps: Korben Trollone's Office - UNDERGROUND TILE D

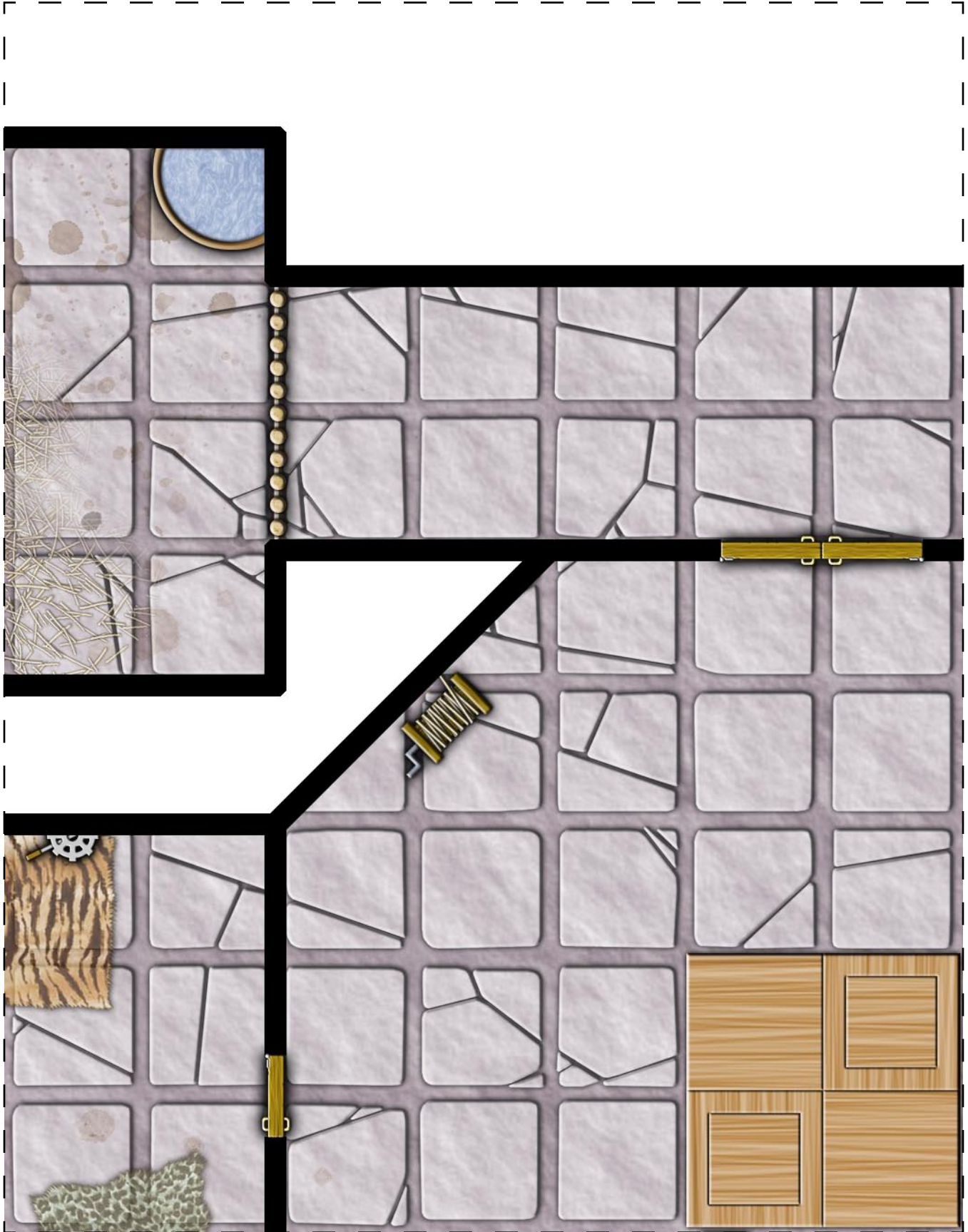

Ptolus Adventure Maps: Korben Trollone's Office - UNDERGROUND TILE E

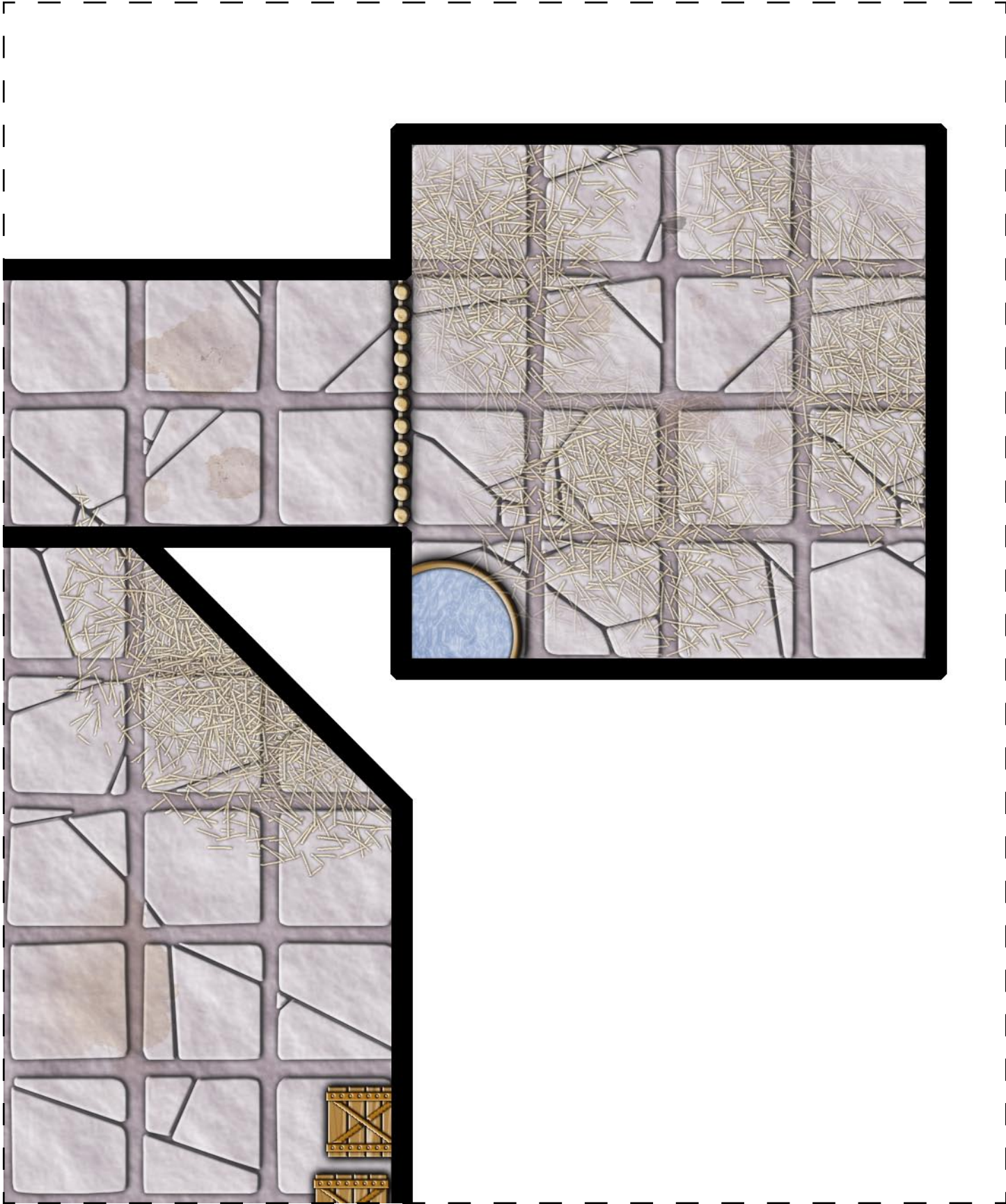

Keeping Things Secret

The secret areas of the building are presented as separate maps that can be trimmed out and put down after players discover them. Secret doors and other hidden details are not depicted on the maps. See the diagram below for information on all the hidden surprises featured in Korben Trollone's office.



S = Secret Door
P = Secret Peep Hole

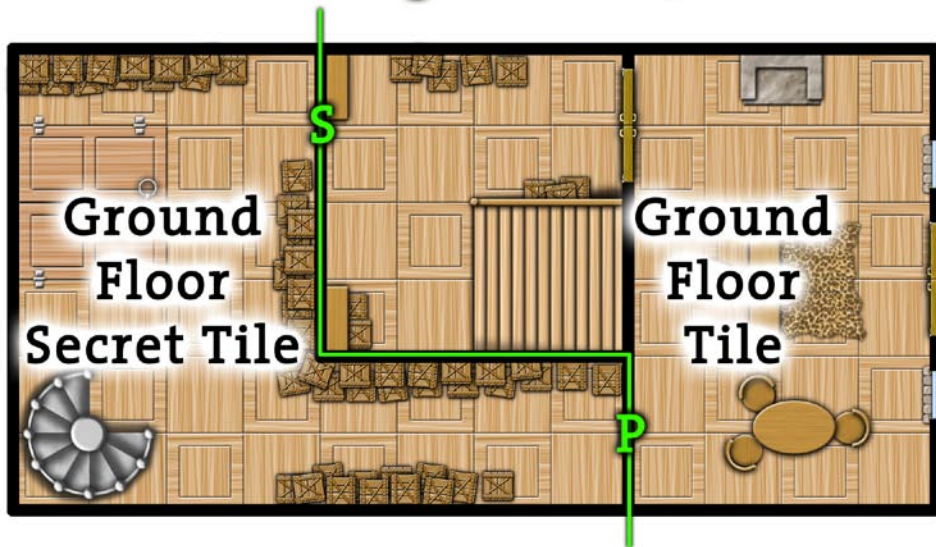

Ptolus Adventure Maps: Korben Trollone's Office - GROUND FLOOR SECRET TILE

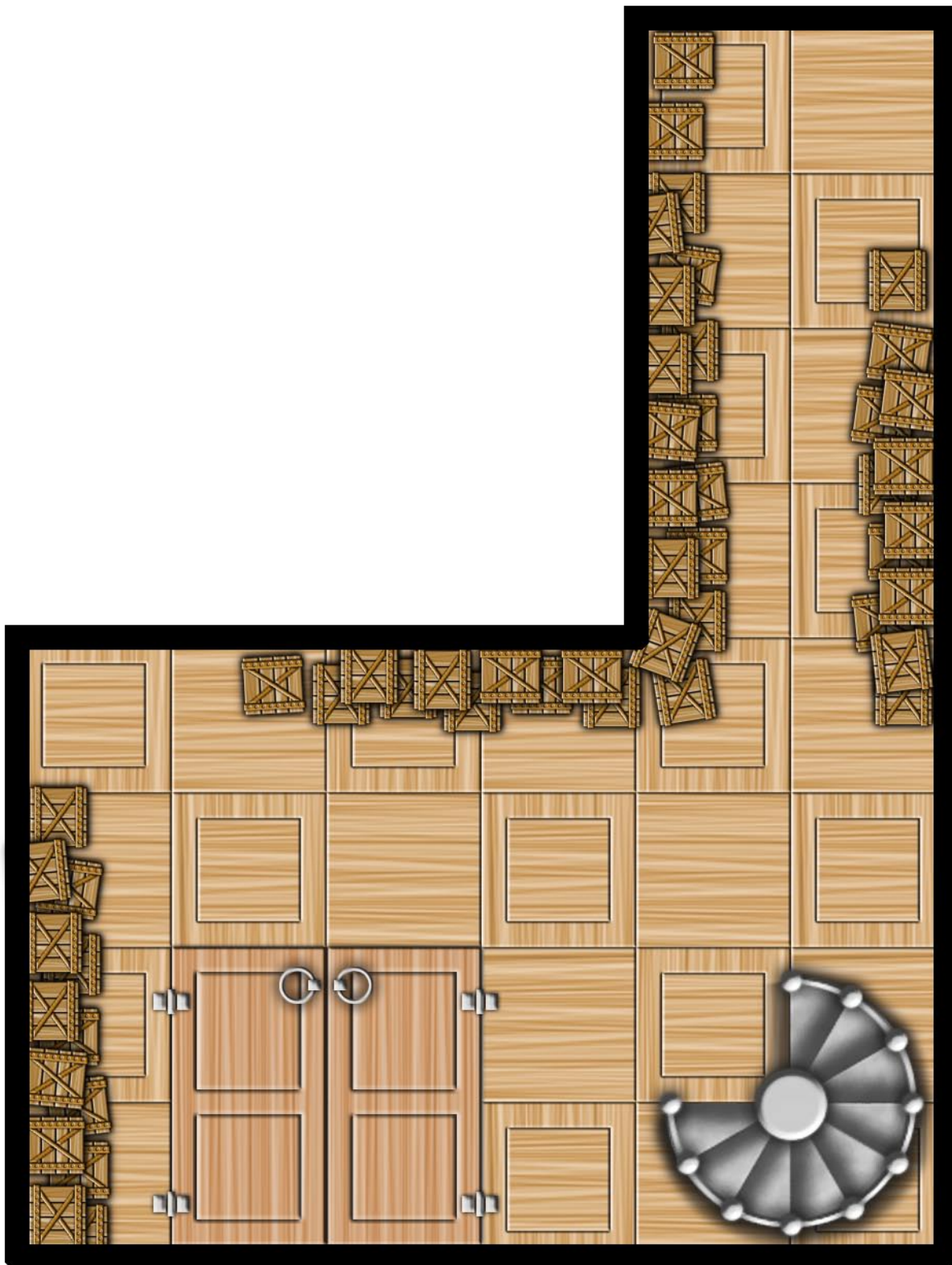

Ptolus Adventure Maps: Korben Trollone's Office - GROUND FLOOR TILE



Ptolus Adventure Maps: Korben Trollone's Office - SECOND FLOOR SECRET TILE



Ptolus Adventure Maps: Korben Trollone's Office - SECOND FLOOR TILE



NOW THAT YOU HAVE THE BOOK,
WHY NOT HAVE THE KEY TO THE CITY?

Ptolus

Ptolus Deluxe City Map

The Deluxe City Map is a tiled version of the Ptolus map with city and district labels. When printed and fully assembled it measures 84 x 56 inches -- perfect for wallpapering your game room.

Available Now • PDF Exclusive • \$9.99

Ptolus Deluxe Map Pack

The Deluxe Map Pack presents all the interior maps from the book in an easy to print format with both labeled and unlabeled versions. Many of the maps are presented much larger than they appear in print.

August 2006 • PDF Exclusive • \$9.99

Ptolus Adventure Maps

This series presents miniatures scale versions of some of the specific areas found within Ptolus. Sets will include The Ghostly Minstrel, Temple of the Rat God, and the Dark Reliquary. Your first one, "Korben Trollone's Office," comes free on the CD-Rom in Ptolus!

Beginning Summer 2006
PDF Exclusive • \$5.99 and up

Ptolus e-Adventure Tiles

This series covers miniatures scale tiles of the "typical" areas within Ptolus. These versatile sets will include the Necropolis, Tavern Row, Warrens, and more, and allow you to create your own locations within the city.

Beginning Summer 2006
PDF Exclusive • \$7.99 and up

SkeletonKey Games is bringing even more detail to Monte Cook's City by the Spire with official tie-in map accessories. These include GM and player aids as well as miniatures-scale tiles and maps for key areas of the setting -- all designed by Ptolus cartographer Ed Bourelle.

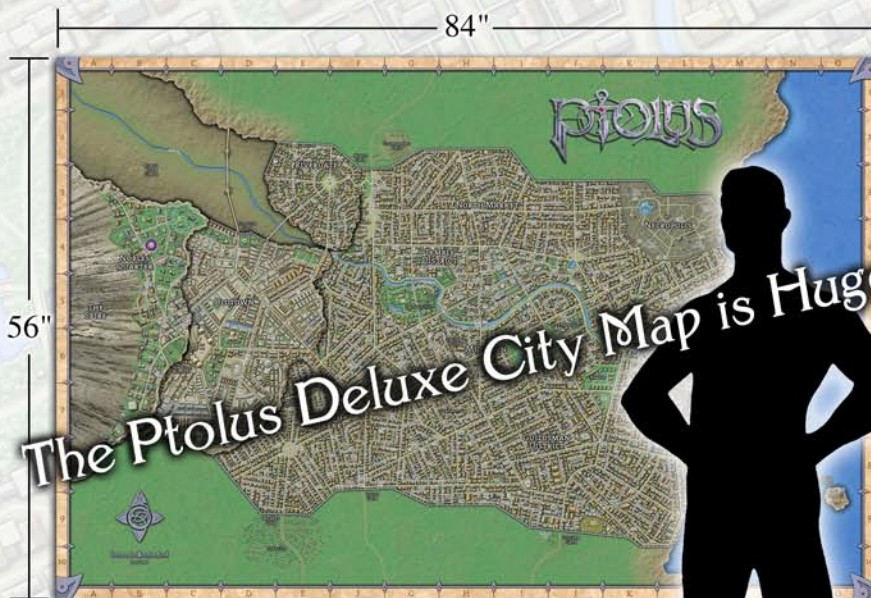

Miniatures scale maps and tiles bring the city to your tabletop.



For more information visit
www.skeletonkeygames.com

SKELTONKEY
GAMES

